



Ibis Golf & Country Club

Lot 9 at Bent Creek

- 4,790 sq. ft. under air
- 6,418 sq. ft. total
- Mediterranean style architecture
- Many plans & sizes to choose from
- Home to be built with pool and spa
- Pictured home is a similar home to floor plan

Lot Price: \$ 450,000.00

Home Price: \$ 1,300,000.00

Total Package: \$ 1,750,000.00

Contact Brett Handler

Dreamstar Custom Homes is a custom home builder located in Palm Beach Gardens. Dreamstar specializes in North Palm Beach County Country Club and Waterfront Community custom homes, renovations and remodels. We are a full service design/build firm with in-house architectural design capabilities.

All prices are subject to change without notice. These drawings are artists' renderings, conceptual only, and the builder expressly reserves the right to make modifications. All features, dimensions and specifications are subject to change without notice. All references to clubs, golf clubs and membership opportunities and other amenities are subject to fees, dues and availability. This is not intended to be and does not constitute an offer in any state or jurisdiction where prohibited by law.

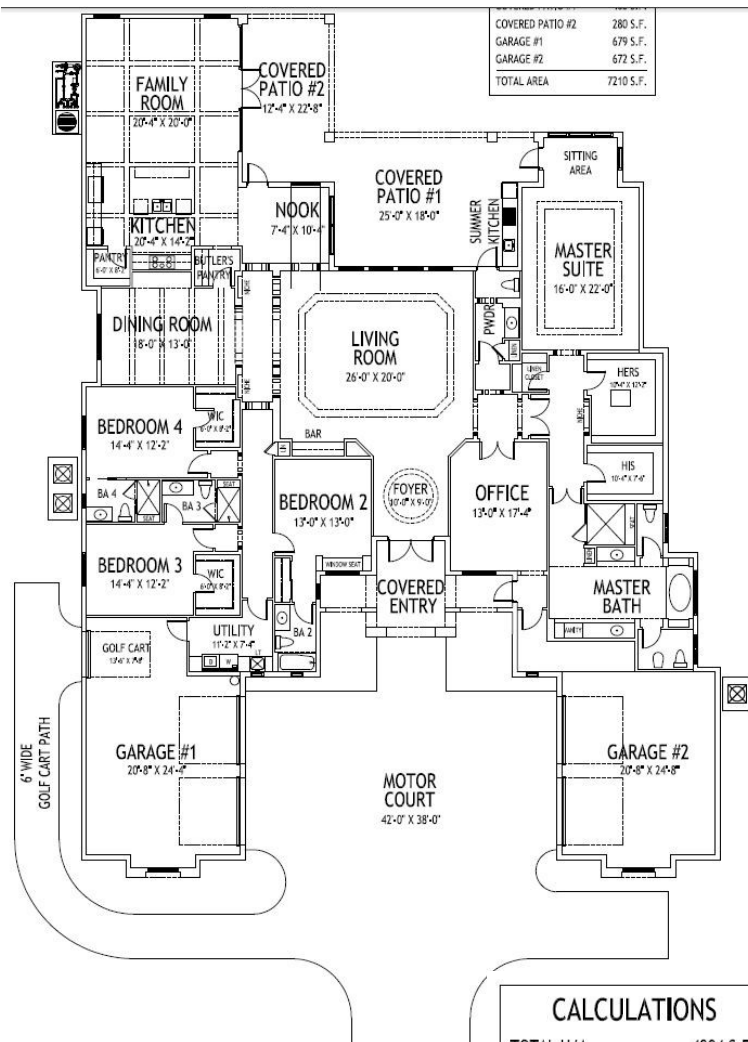

CALCULATIONS	
TOTAL U/A	4904 S.F.
COVERED ENTRY	212 S.F.
COVERED PATIO #1	463 S.F.
COVERED PATIO #2	280 S.F.
GARAGE #1	679 S.F.
GARAGE #2	672 S.F.
TOTAL AREA	7210 S.F.

Shops at Village Square • 420 U.S. Highway One, Suite 15 • North Palm Beach, FL 33408
Tel. 561.799.7777 / 561.694.7750 • www.DreamstarFL.com

CBC 1258890



CERTIFIED
GREEN
PROFESSIONAL™



Network Association
of Home Builders



ENERGY STAR
PARTNER



GOLD COAST BUILDERS ASSOCIATION

